



Matanuska-Susitna Borough
 Planning & Land Use Department
 Development Services Division
 350 East Dahlia Avenue
 Palmer, Alaska 99645



U.S. POSTAGE >> PITNEY BOWES
 ZIP 99645 \$ 000.46⁰
 02 1W
 0001399405 JUN 21 2017

7

SUTTON COMMUNITY COUNCIL
 PO BOX 344
 SUTTON, AK 99674

FIRST CLASS MAIL

The Planning Commission of the Matanuska-Susitna Borough will consider the following:

- Application:** Conditional Use Permit for a Marijuana Retail Facility
- MSB Code Section:** MSB 17.60 – Conditional Uses
- Applicant:** Chad & Lynette Kudlacek, dba Hilltop Premium Green
- Location:** 13856 N. Glenn Highway (Tax ID# 19N03E28B007);
within Township 19 North, Range 3 East, Section 28, Seward Meridian
- Request:** An application for a conditional use permit under MSB 17.60 – Conditional Uses, has been submitted for the operation of a marijuana retail facility.

The Planning Commission will conduct a public hearing concerning the following application for a conditional use permit on Monday, **August 21, 2017 at 6:00 p.m.** in the Borough Assembly Chambers, 350 E. Dahlia Avenue, in Palmer. This may be the only presentation of this item before the Planning Commission and you are invited to attend. The Planning Commission members may submit questions to the Planning Commission Clerk concerning the matter or request for more information from the applicant at the time of introduction. All questions and requests submitted by the Commission shall be in writing and copies will be provided to the applicant and made available to all interested parties and the public upon request. Answers to questions and additional material requests will be addressed in the staff report for the public hearing. Commission members may not receive or engage in ex-parte contact with the applicant, other interested parties in the application, or members of the public concerning the application or issues presented in the application.

Application materials may be viewed online at www.matsugov.us by clicking on 'All Public Notices & Announcements'. Application material may also be viewed at the Borough Permit Center. For additional information, you may contact Mark Whisenhunt, Planner II, at 861-8527. Written comments can be mailed to: MSB Development Services Division, 350 E. Dahlia Avenue, Palmer, AK 99645. You may fax comments to 861-8158 or e-mail to mwhisenhunt@matsugov.us. In order to be eligible to file an appeal from a decision of the Planning Commission, a person must be designated an "interested party" under MSB 15.39.010 for the definition of "interested party". The procedures governing appeals to the Board of Adjustment and Appeals are contained in MSB 15.39.010-250, which is available on the borough home page: www.matsugov.us, in the Borough Clerk's office, and at various libraries within the borough.

Comments are due on or before **July 18, 2017** and will be included in the Planning Commission packet for the Commissioner's review and information. Please be advised that comments received from the public after that date will not be included in the staff report to the Planning Commission

Name: _____ **Mailing Address:** _____

Location/Legal Description of your property: _____

Comments: _____

Note: Vicinity Map Located on Reverse Side

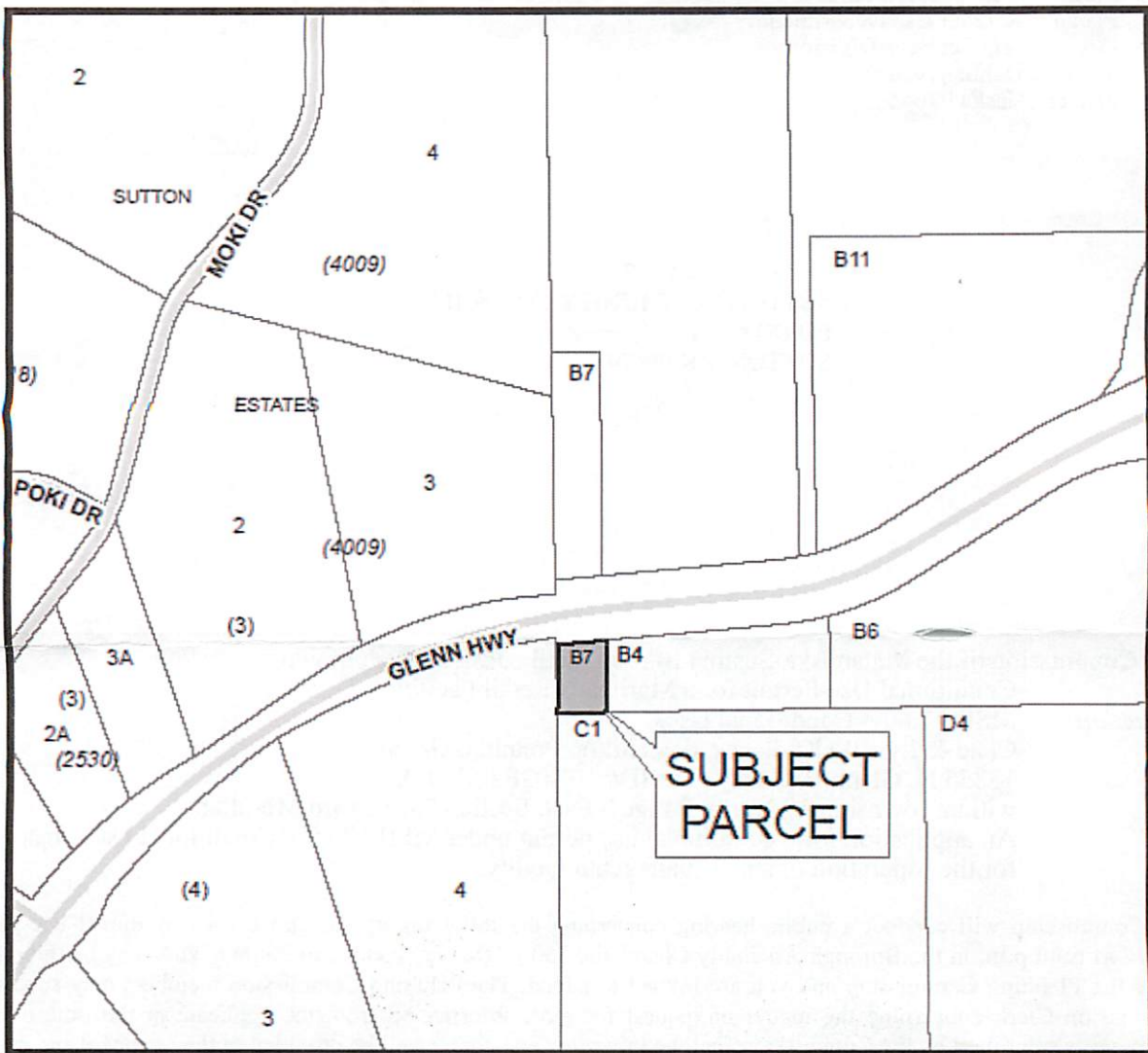

19N03E28B007



This map is solely for informational purposes only. The Borough makes no express or implied warranties with respect to the character, function, or capabilities of the map or the suitability of the map for any particular purpose beyond those originally intended by the Borough. For information regarding the full disclaimer and policies related to acceptable uses of this map, please contact the Matanuska-Susitna Borough GIS Division at 907-861-7801.



MBS Information Technology/GIS
June 13, 2017

